

Step 03 Insert TORQ® Body and start operation

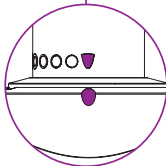

Removal position

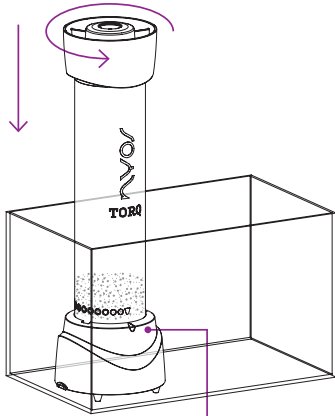

Setting the flow rate

1. Fit the body on the dock in the removal position (Fig. 5)
2. Plug in the dock
3. It is possible to change the flow rate by rotating the body.
4. Set the flow rate so that the filter media will be hold in suspension

NOTE: A smear layer will form after a few days. This will result in a quieter return flow and bubble formation will reduce.

Manufactured by
Nynos® Aquatics GmbH,
Siemensstr. 26,
70825 Korntal-Muenchingen, Germany
www.nynos.info, info@nynos.info

(Fig. 5)

NYOS® TORQ® QUICK START

Full instructions and safety information



Video instructions and tips

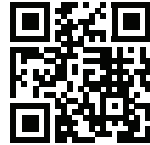

Step 01 Positioning the TORQ® Dock in the sump

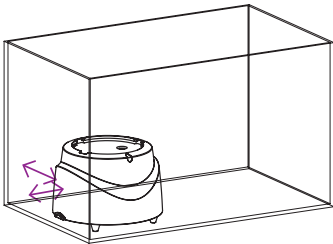

(Fig 1)

- In sump use only
- Avoid contact to side panes
- Only plug in, when the body is on the dock

Step 02 Filling the TORQ® Body

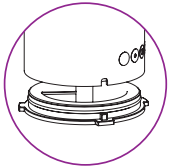
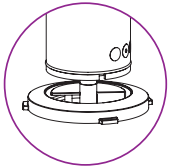

(Fig. 2)

General Information

- The groove in the acrylic tube and the lug on the screen insert must sit on top of each other during assembly (Fig. 2)

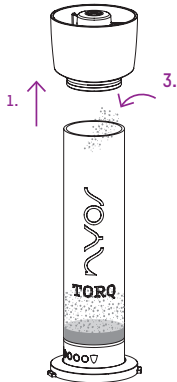

(Fig. 3)

Filling with one filter media

1. Remove lid
2. Only body 1.0 and 2.0: Remove separating screen
3. Add filter media and put the lid back on

Filling with two filter media (only TORQ® Body 1.0 and Body 2.0)

1. Turn body upside down and remove screen insert and separating screen
2. Add filter media to the top chamber
3. Insert filter sponge without hole and separating screen. Add second filter media, hold the acrylic stick firmly while doing so.
4. Close the body by fitting the screen insert

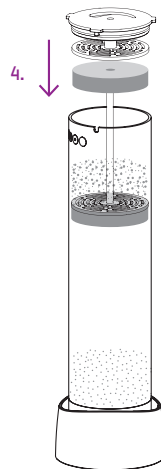
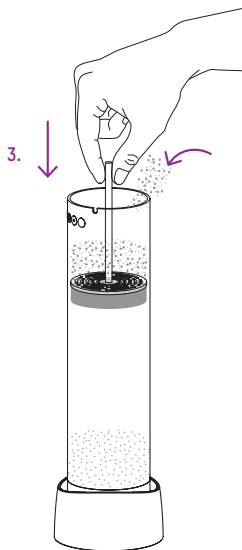
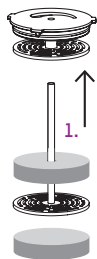

(Fig. 4)