

# RMS Tank Mount System

Mounting Instructions for Radion XR30 and XR15 LED Models

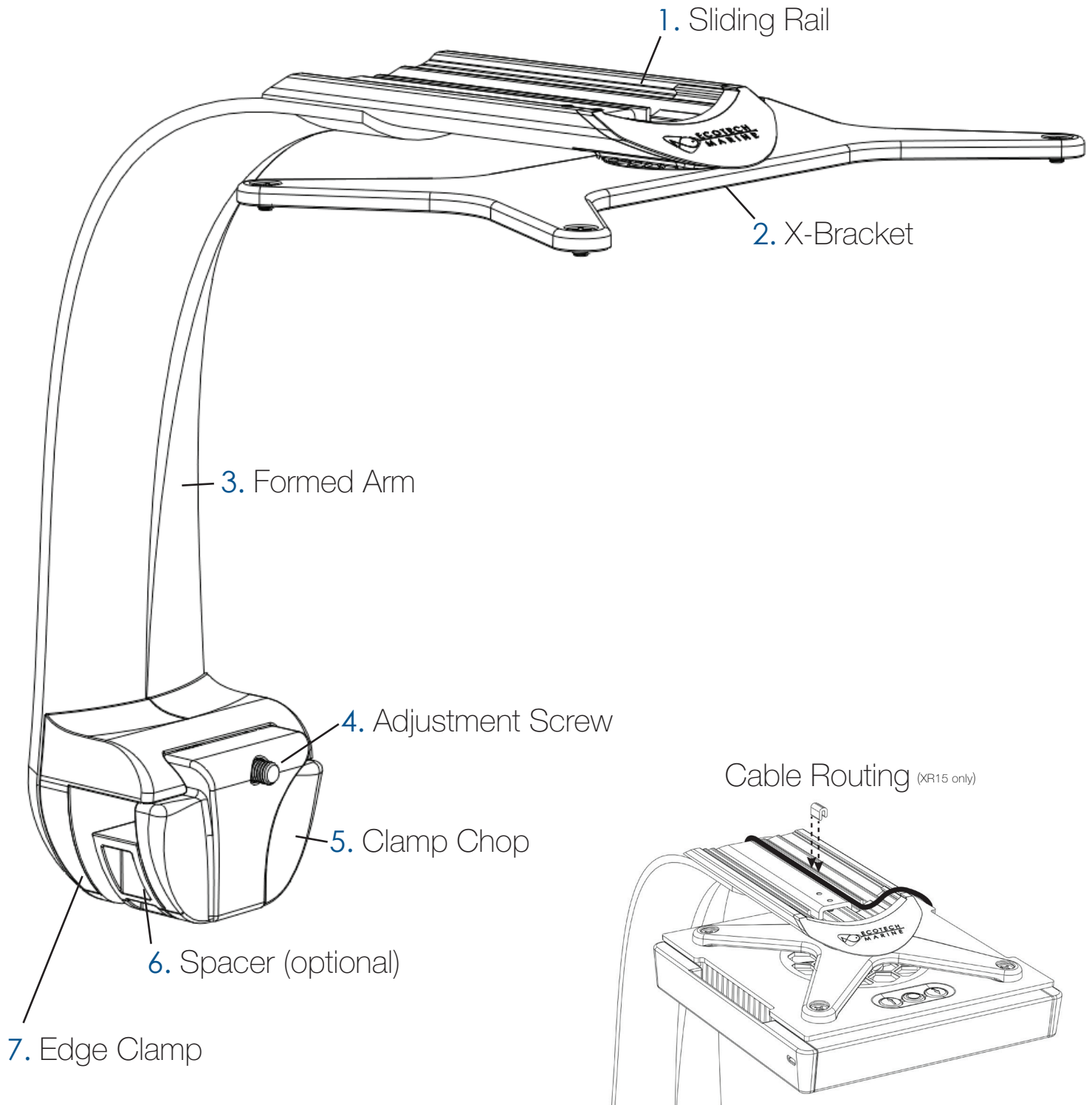

**i** Make sure that all you have all components included in this kit before beginning. If something is missing contact EcoTech Marine service at 1-800-785-0338 ext.2 with any questions, requests or comments.

# Kit Assembly Instructions

## 1. Choose appropriate Spacer configuration

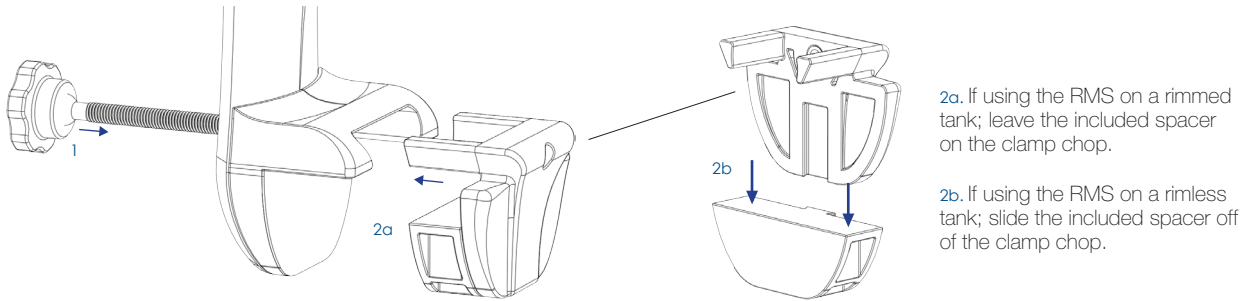

## 2. Mount RMS assembly to tank

WARNING: Do not over tighten clamp, over-tightening may result in damage to your tank or RMS assembly.

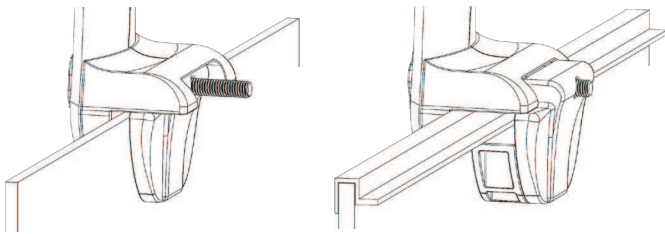

## 3. Choose appropriate Sliding Rail for desired front to back position

\*XR15 Kit only includes two Sliding Rails.

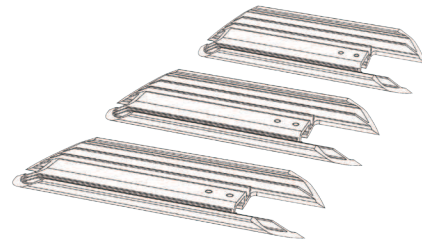

## 4. Insert X-Bracket assembly into the end of the Sliding Rail and tighten down screws

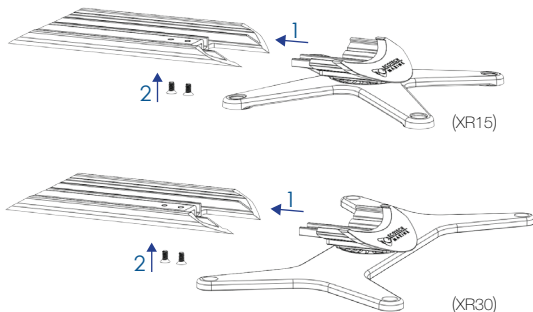

## 5. Attach Radion to X-Bracket

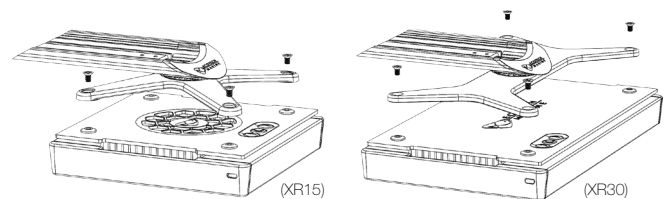

## 6. Guide Sliding Rail onto Formed Arm over the locking nut and tighten screw in desired position

